

Playa Installation Guide

Read this guide and review shop drawings and notes before beginning installation.

All packages should be opened and inspected for hidden damage upon receipt. Any missing or damaged components should be noted on the delivery receipt with the carrier before accepting the shipment. All items should be repackaged and stored where protected from moisture, dirt, and excessive heat. Do not wrap material so that heat or moisture can become trapped. Ensure that items are level, fully supported, and have airflow between parts. Damage from improper storage is not considered shipping damage and is not covered by product warranties. Handle materials so as to protect materials, coatings, fabric and finishes during transportation and installation to prevent damage or staining.

It is the responsibility of the installer to meet or exceed all code and safety requirements, and to obtain all required building permits. These instructions are only a guide, and may not address every circumstance. The installer should determine and implement appropriate installation techniques for each situation. Structureworks shall not be held liable for improper or unsafe installations.

Recommended Tools

The tools required for installation will vary depending on structure configuration and the hardware used. Review shop drawings to confirm drill bit sizes, socket sizes, and other project specific tools.

- Pencil
- 4' Level
- 8' Ladder (2)
- Framing Square
- Hacksaw/Bolt Cutters
- Caulk Gun
- Impact Driver w/ Phillips Bit
- Adjustable Wrench
- Tape Measure
- Socket Wrench w/ Deep Sockets
- Drill
- Right Angle Adapter for Impact Driver or Drill
- Circular Saw w/ Abrasive Blade
- Compressed Air
- Hole-Cleaning Brush

Required Materials

Depending on the configuration of the structure, additional materials such as ledger attachment hardware, silicone caulk, and anchoring epoxy may be needed. Review shop drawings for project specific requirements.

Cleaning and Maintenance

Use a combination of Simple Green All-Purpose Cleaner and hot water with a soft bristle brush. Clean after installation and on an annual basis. For more difficult to clean marks, a Mr. Clean Magic Eraser can be used. Structural attachments should be inspected annually.

Installation Sequence

This installation guide provides a step by step sequence for the installation of the structure. This guide covers only the structure, separate installation guides are provided for accessories and other products used in the installation of the structure. Ensure that you have all required installation guides before beginning the installation.

All structures are made to order and are provided with shop drawings. Shop drawings may contain additional information, details, or job specific instructions. Shop drawings take precedence over this installation guide.

Layout and Install Columns

Layout all columns according to the shop drawings. Columns must be located precisely and variations in the height of the mounting surface must be accounted for by trimming or leveling each column. The structure will not install correctly if the columns are installed out of square or out of level from one another. Refer to Fiberglass Column Installation Guide for more information.

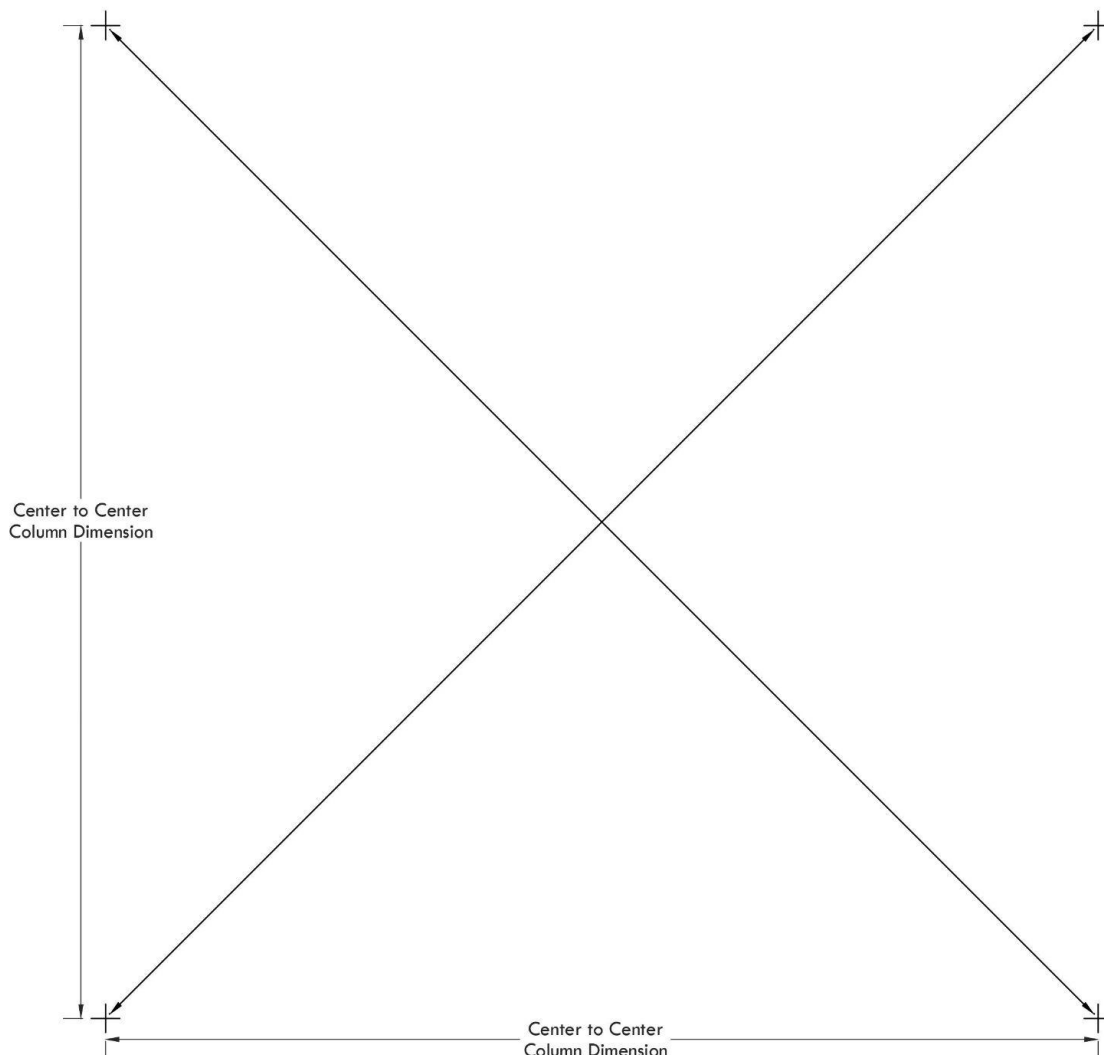

Install Brackets and Ledger - Attached Structures Only

Install the external rafter brackets on top of the ledger using screws. Mount the ledger to the host structure, ensuring it is secured to structural components capable of supporting the load. Attachment hardware is not provided and should be selected based on the specific mounting conditions.

Hardware may be installed through the face of the ledger and left exposed, or access holes can be drilled to allow for concealed installation. If concealed, insert hole plugs after installation to cover the access points.

Do not overtighten the fasteners securing the ledger to the host structure.

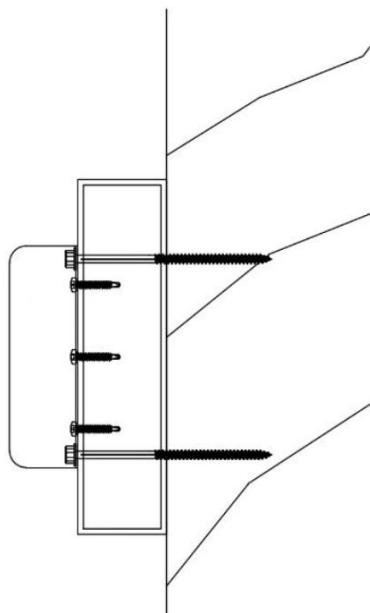
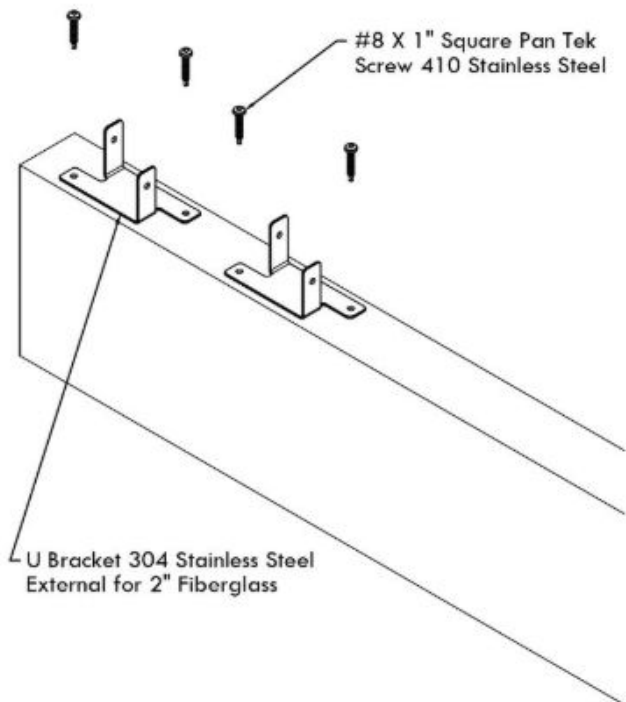

Exposed Hardware

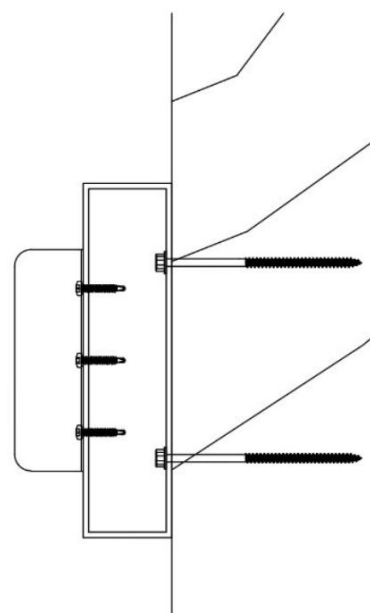

Concealed Hardware

Install Brackets and Beams

Mark the rafter center locations on the tops of each beam. Attach the rafter brackets at the marked location using screws. Place the beams on top of the columns and secure to the double beam adapter with screws.

If the structure includes integrations such as lighting, fan wiring, or heaters, complete all wiring, make necessary connections, and test them before installing the beams.

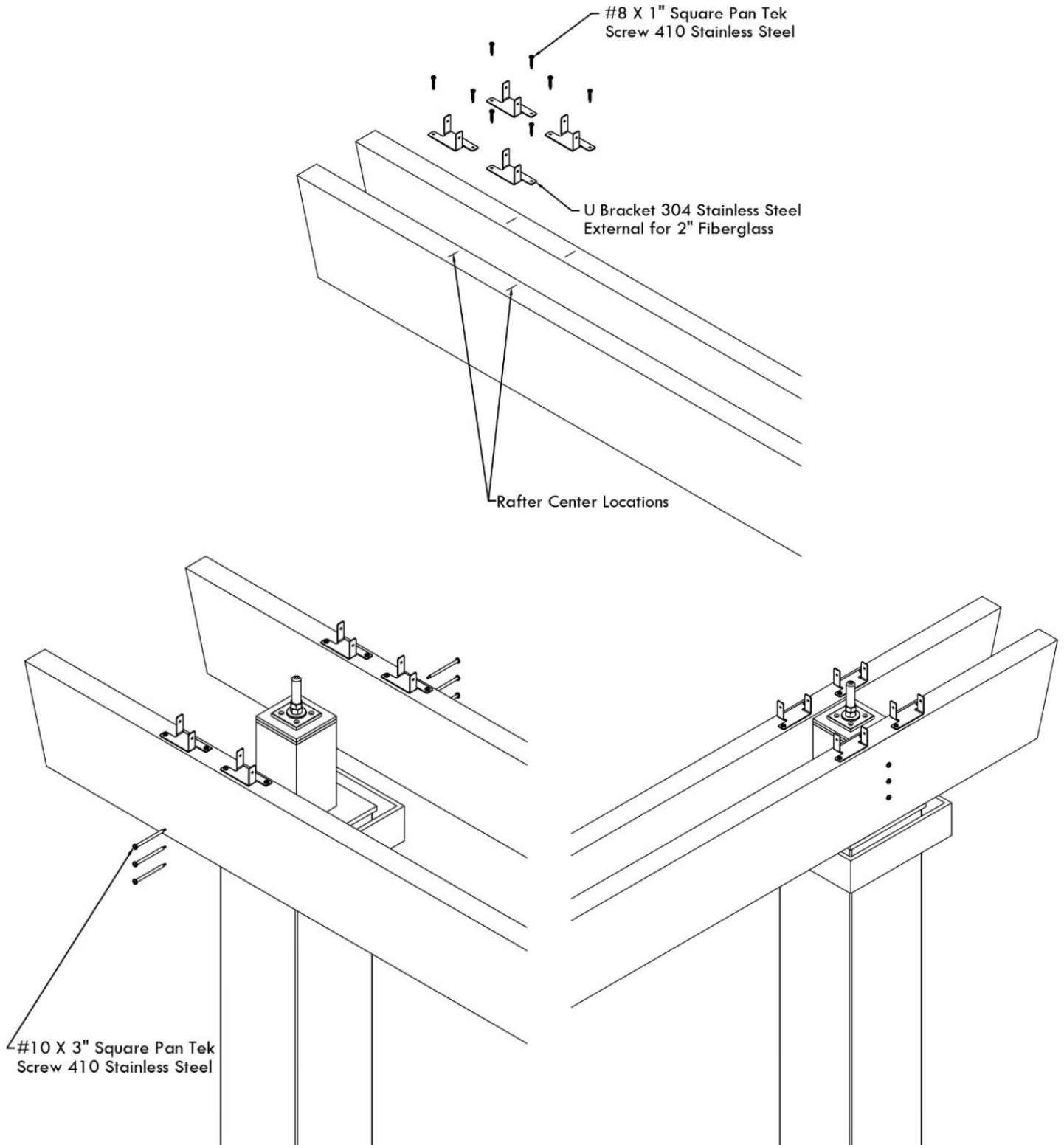

Install Rafters

For a freestanding structure, position a rafter across both double beam assemblies. For an attached structure, position the rafter between the ledger and the double beam assembly. Verify that the spacing between the supports (double beams or ledger) matches the specified distance in the shop drawings. Ensure the rafter is level, then secure it in place with screws.

Due to limited space between rafters, a right-angle drill adapter is required for some screw installation.

Repeat this process for all remaining rafters, confirming that their placement matches the layout shown in the shop drawings.

If the structure includes fan or canopy blocks, or integrations such as lighting or wiring, install the necessary brackets and blocking per the instructions. Complete all connections, route the wiring, and test the system before final rafter installation.

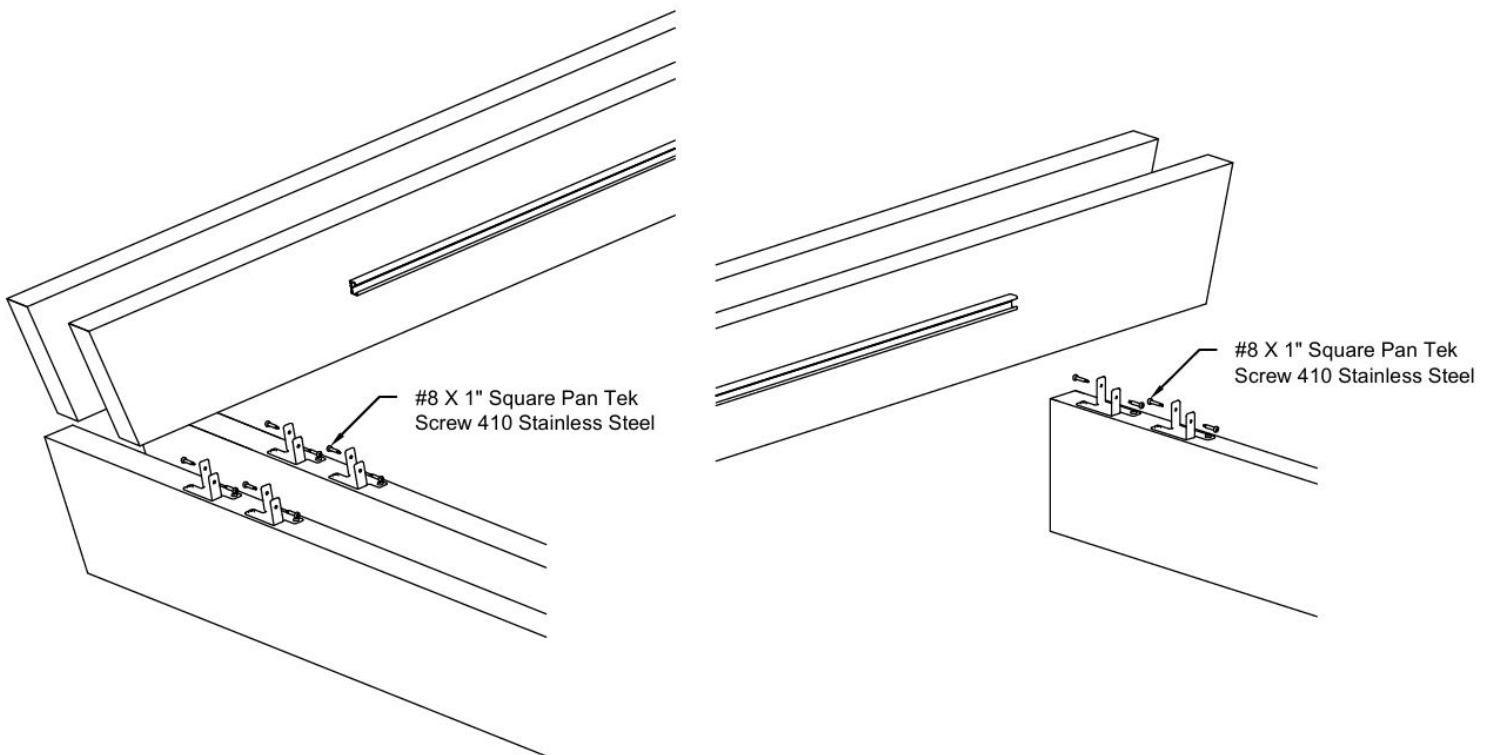

Install Keystones

Keystones are provided to cover seams and hardware on beams and rafters. Attach each Keystone using screws to secure in place..

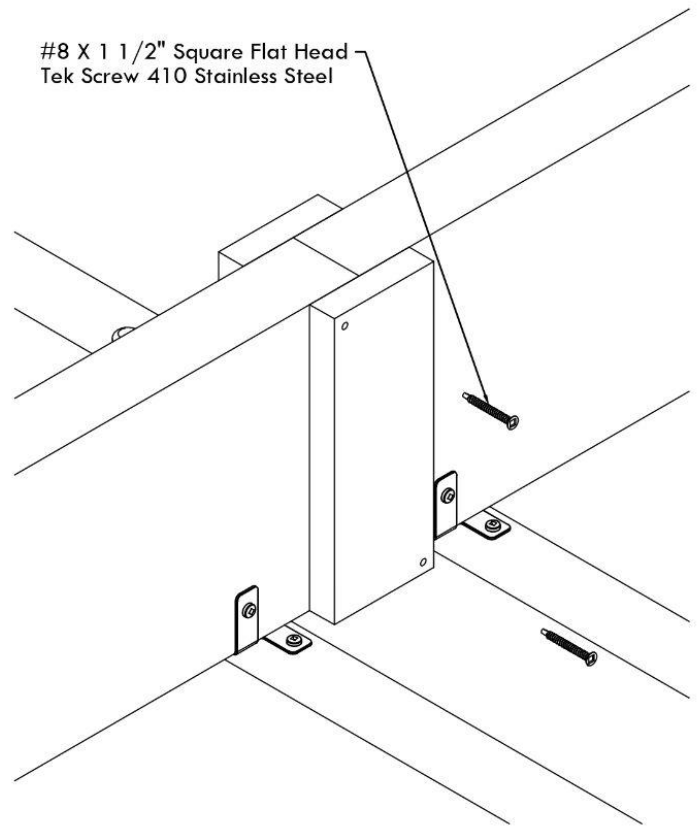
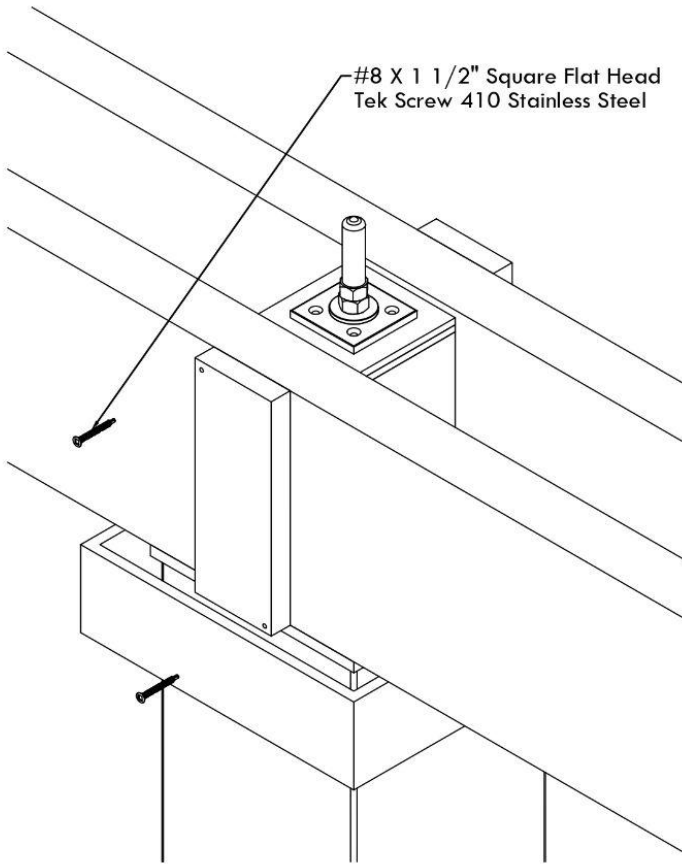

Other Conditions

Beam to Wall Connection

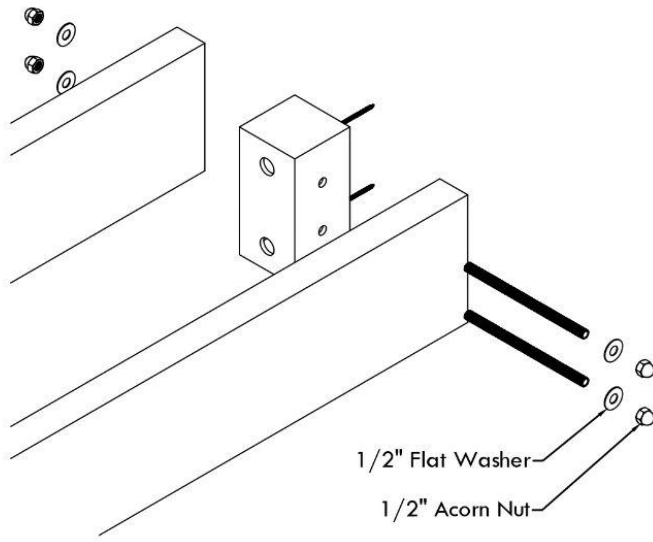

Angled Beam Connection

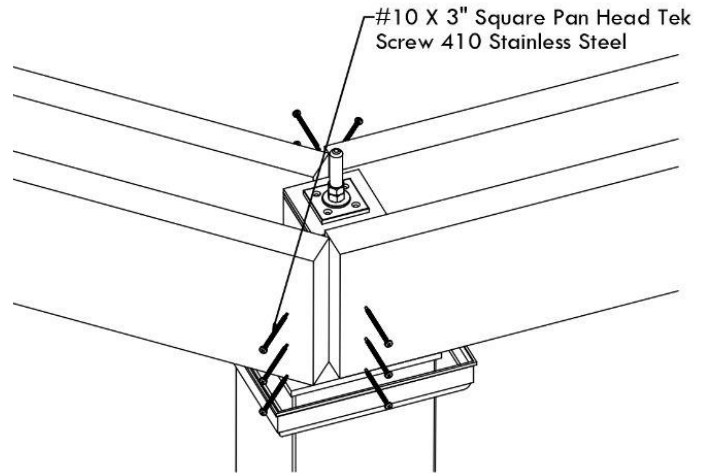

Beam Blocking

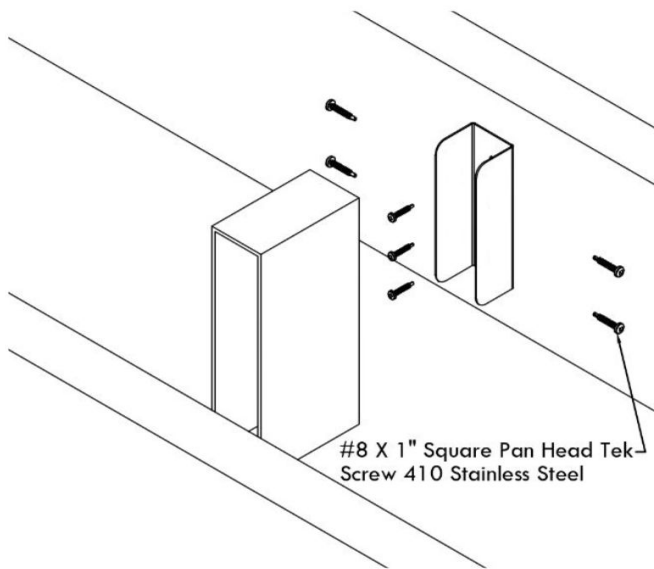

Angled Rafter Connection

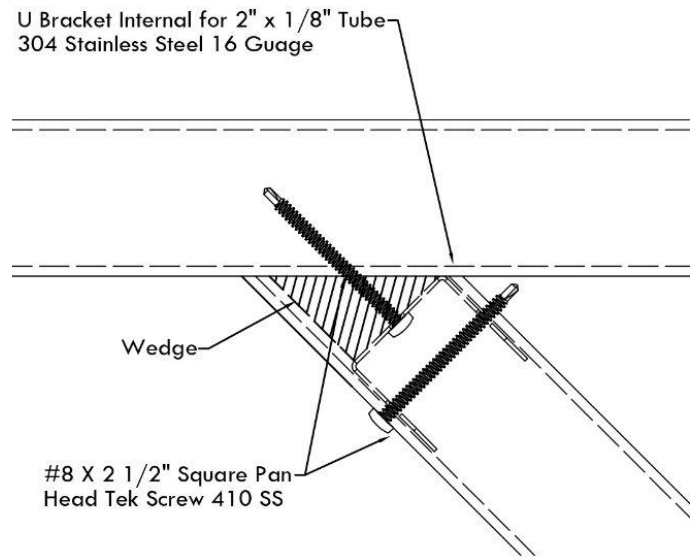

Paint Touch-Up

All ColorLast finished structures will require touch up over time and at completion of construction. Use extreme care when handling painted components. Touch up paint is provided. In the event of scratching or cracking, touch up the painted surface with a foam or bristle brush. Apply light coats in order to allow the paint to dry with a smooth finish.

Water Drainage

Drill weep holes in the bottom of all hollow components to allow for proper water drainage. Without adequate drainage, water buildup can cause damage to the finish or structure, which is not covered under warranty.