

# MARQUIS FIBERGLASS STRUCTURE

## Exterior Sun Control 10 71 13



Marquis fiberglass shade structures are designed and manufactured in freestanding and attached configurations that are made to your specification in almost any size and shape.

Marquis includes manually retractable ShadeTree canopies, which are offered in either 100% solution dyed acrylic fabrics for solid shade or AirFlow mesh fabric for partial shade.

Marquis is supported with fiberglass columns available in round, round tapered, square and square tapered configurations. Beams and rafters may be finished with a traditional, classic, coast, flat, clip, arcadia, belmont, slight, or custom designed end detail.

Fiberglass components are mechanically fastened using stainless steel hardware. All materials come pre-finished with our exclusive ColorLast finish.

Marquis includes all components, most installation hardware and complete installation documentation as specified and required for a quality installation.

Marquis is designed, engineered and manufactured by Structureworks.

### **Structure Configuration:**

Freestanding or Attached to host structure

### **Component Material:**

Pultruded fiberglass reinforced polymer

### **Component Sizes:**

2 x 8" Double Beams, 2" x 8" Rafters, 2" x 8" Ledger, 1 3/4" x 1 3/4" Stringers

### **Component End Detail:**

Traditional, classic, coast, flat, clip, arcadia, belmont, slight, or custom designed end detail

### **Column Size:**

10" Round Tapered, 12" Round Tapered, 8" Square, 10" Square, 12" Square Tapered, other sizes and shapes available

### **Component Attachment:**

Mechanical, with stainless steel hardware

### **Canopy:**

AirFlow Mesh or 100% solution-dyed acrylic fabric

### **Column Attachment:**

Exclusive Tension-Rod Mounting System with hardware for surface or through bolt mount to concrete or wood framing, Aluminum reinforced fiberglass column with welded base plate for surface or through bolt mount to concrete or wood framing.

### **Integrations:**

Aura low-voltage lighting can be integrated into structure components and columns. Wiring and mounting provisions can be included for accessories such as fans, heaters, and A/V equipment.

**STRUCTUREWORKS®**

877.489.8064 • [www.structureworks.com](http://www.structureworks.com)



### Submittals

Structureworks will submit shop drawings illustrating plans, elevations, sections and details showing spacing of components and connections. We can provide 2D and 3D CAD files for project specific drawings, as well as samples of material finish and color options.

As required, Structureworks can perform structural engineering services and submit an engineered plan set prepared by a licensed professional engineer.

### Finish

Fiberglass structures are finished using our proprietary ColorLast process. Choose from a selection of standard colors in a matte finish or provide custom color for matching.

### Engineering

Engineering is a critical step in many projects. Structureworks will engineer a shade structure as part of the design process. Our engineering department handles the loads and calculations, foundation, frame, and connections design, and issues stamped plan sets for permitting.

Licensed in 50 states and DC, Structureworks can engineer a shade structure to meet your project requirements.

### Maintenance

Fiberglass structures are designed to provide a long service life with very little maintenance. Fiberglass shade structures finished with our exclusive ColorLast process will provide an attractive, high quality finish for many years. Inspect mechanical fasteners yearly and adjust as needed.

### Warranty

Limited-Lifetime warranty for structures in residential applications. 30-Year Limited warranty for structures in commercial applications. 20-Year Limited warranty on ColorLast Finish.

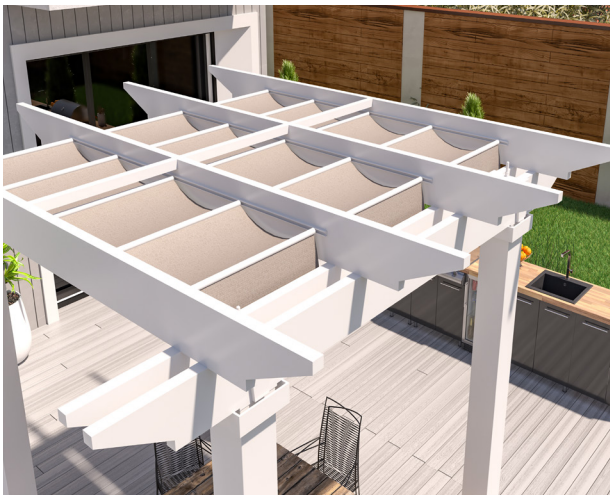
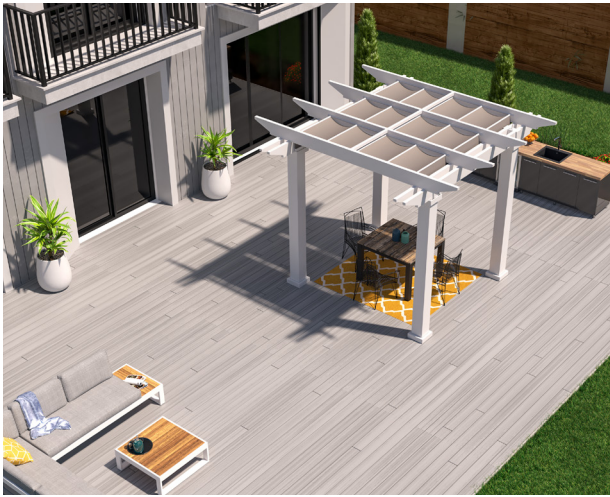

Notes: